

WALL MOUNTING PLATE AND FLANGE DETAIL

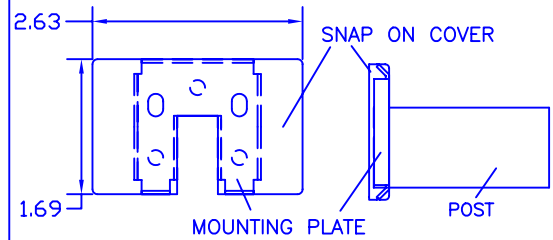

REV.#	DATE	DESCRIPTION	INITIALS	TOILET PAPER HOLDER		Brey-Krause Mfg. Co. 1209 West Lehigh St. Bethlehem, PA 18018 Ph. (610)867-1401 Fax (610)866-1433 e-mail: info@brey-krause.com
				MATERIALS: POSTS TYPE- 304 SS .029 THICK ROLLER: WHITE PLASTIC ASSEMBLY IS FABRICATED FROM TYPE 304 STAINLESS STEEL. MOUNTING BRACKET IS WELDED TO POST. FLANGE COVER SNAPS OVER MOUNTING BRACKET TO CONCEAL MOUNTING SCREWS. SPECIFY FINISH: SS=SATIN BS=BRIGHT		
				DATE	5-20-99	
				DRAWN BY	R.D.F.	
				SCALE		